

British Standard Precision Roller Chain Conforming to ISO 606 and DIN 8187

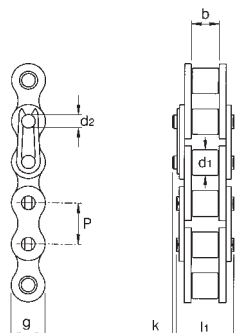

Simplex Roller Chains

Email sales@crossmorse.com



Cat No.†	Pitch P	Inside Width b min mm	Roller Dia. d1 max. mm	Pin Dia. d2 max. mm	Plate Depth g mm	Pin Length l1 max. mm	Con Pin Ext. k mm	Transverse Pitch e mm	Bearing Area cm ²	Tensile Strength N	Approx Weight kg/m
04 B†	6mm	2.80	4.00	1.85	5.0	7.4	2.9		0.07	3,000	0.12
05 B-1	8mm	3.00	5.00	2.31	7.1	8.6	3.1		0.11	4,600	0.18
06 B-1	3/8 inch	5.72	6.35	3.28	8.3	12.8	2.2		0.28	9,100	0.41
08 B-1	1/2 inch	7.75	8.51	4.45	11.8	16.2	2.1		0.50	18,200	0.70
081-1	1/2 inch	3.30	7.75	3.66	9.9	10.2	1.5		0.21	8,200	0.28
083-1	1/2 inch	4.88	7.75	4.09	10.3	12.9	1.5		0.32	12,000	0.42
084-1	1/2 inch	4.88	7.75	4.09	11.1	14.8	1.5		0.35	16,000	0.59
08L †	1/2 inch	6.40	7.75	3.97	11.5	15.1	2.0		0.38	16,000	0.53
08N †	1/2 inch	4.88	7.75	3.66	9.9	10.9	2.8		0.28	8,200	0.33
086 †	1/2 inch	5.21	8.51	4.45	11.6	15.0	3.9		0.39	18,200	0.62
101 †	5/8 inch	6.48	10.16	5.08	15.0	16.0	3.5		0.51	22,700	0.80
10 B-1	5/8 inch	9.65	10.16	5.08	14.7	18.6	2.2		0.67	22,700	0.96
12 B-1	3/4 inch	11.68	12.07	5.72	16.1	21.9	2.6		0.89	29,000	1.23
16 B-1	1 inch	17.02	15.88	8.28	21.1	35.6	3.1		2.10	64,000	2.60
20 B-1	1 1/4 inch	19.56	19.05	10.19	26.3	41.0	3.1		2.95	98,000	3.70
24 B-1	1 1/2 inch	25.40	25.40	14.63	33.3	53.4	3.5		5.54	170,000	6.90
28 B-1	1 3/4 inch	30.99	27.94	15.90	37.0	65.8	3.6		7.40	200,000	8.60
32 B-1	2 inch	30.99	29.21	17.78	40.6	64.8	3.8		8.11	260,000	9.50

† Cat No. equates to ISO 606 Chain ref. except where indicated, which are chains to factory std.

Fax +44(0) 121 325 1079

Duplex Roller Chains

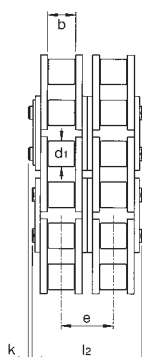

Cat No.†	Pitch P	Inside Width b min mm	Roller Dia. d1 max. mm	Pin Dia. d2 max. mm	Plate Depth g mm	Pin Length l2 max. mm	Con Pin Ext. k mm	Transverse Pitch e mm	Bearing Area cm ²	Tensile Strength N	Approx Weight kg/m
05 B-2	8mm	3.0	5.0	2.31	7.1	14.3	3.1	5.64	0.22	8,000	0.36
06 B-2	3/8 inch	5.72	6.35	3.28	8.3	22.9	2.2	10.24	0.55	17,300	0.78
08 B-2	1/2 inch	7.75	8.51	4.45	11.8	30.2	2.1	13.92	1.00	31,800	1.40
10 B-2	5/8 inch	9.65	10.16	5.08	14.7	35.4	2.2	16.59	1.34	45,400	1.80
12 B-2	3/4 inch	11.68	12.07	5.72	16.1	41.4	2.6	19.46	1.78	57,900	2.44
16 B-2	1 inch	17.02	15.88	8.28	21.1	67.6	3.1	31.88	4.21	122,000	5.30
20 B-2	1 1/4 inch	19.56	19.05	10.19	26.3	77.6	3.1	36.45	5.91	187,000	7.45
24 B-2	1 1/2 inch	25.40	25.40	14.63	33.2	101.5	3.5	48.36	11.09	324,000	13.75
28 B-2	1 3/4 inch	30.99	27.94	15.90	37.0	125.2	3.6	59.56	14.81	380,000	17.30
32 B-2	2 inch	30.99	29.21	17.78	40.6	123.0	3.8	58.55	16.23	495,000	18.80

Tel +44(0) 121 360 0155

Triplex Roller Chains

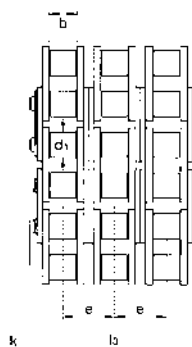

Cat No.†	Pitch P	Inside Width b min mm	Roller Dia. d1 max. mm	Pin Dia. d2 max. mm	Plate Depth g mm	Pin Length l2 max. mm	Con Pin Ext. k mm	Transverse Pitch e mm	Bearing Area cm ²	Tensile Strength N	Approx Weight kg/m
06 B-3	3/8 inch	5.72	6.35	3.28	8.3	32.8	2.2	10.24	0.83	25,400	1.18
08 B-3	1/2 inch	7.75	8.51	4.45	11.8	44.1	2.1	13.92	1.50	45,400	2.10
10 B-3	5/8 inch	9.65	10.16	5.08	14.7	51.9	2.2	16.59	2.02	68,100	2.85
12 B-3	3/4 inch	11.68	12.07	5.72	16.1	60.8	2.6	19.46	2.68	86,500	3.63
16 B-3	1 inch	17.02	15.88	8.28	21.1	99.4	3.1	31.88	6.32	182,000	7.80
20 B-3	1 1/4 inch	19.56	19.05	10.19	26.3	114.9	3.1	36.45	8.86	280,000	11.4
24 B-3	1 1/2 inch	25.40	25.40	14.63	33.2	149.5	3.5	48.36	16.64	485,000	20.5
28 B-3	1 3/4 inch	30.99	27.94	15.90	37.0	184.8	3.6	59.56	22.21	570,000	25.8
32 B-3	2 inch	30.99	29.21	17.78	40.6	181.2	3.8	58.55	24.34	743,000	27.9

Spares for Std. Chains

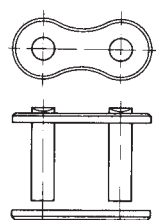

Pin Unit (Rivetting Outer Links)

Available all sizes of chain. Press fit unit to connect chains for maximum performance

Part Ref. 79

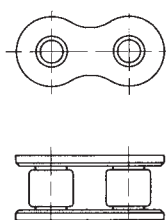

Roller Unit (Inner Link)

Available all sizes of chain to extend chain length or manufacture of special build chains.

Part Ref. 77

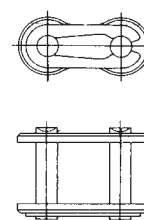

Connecting Link (Spring Clip Type)

Standard all chains to 1 inch pitch. Should be assembled with open end away from running direction of chain.

Part Ref. 76

Stainless Steel, Extended Pitch and Factory Standard Chains



Straight Sideplate Roller Chains to British Standard Dimensions

These provide increased bearing support for conveying applications.

Cat. No.	Pitch P	Inside Width b min. mm	Roller ϕ d: max mm	Pin ϕ d: max mm	Plate Depth g mm	Pin Length k max mm	Bearing Area cm ²	Tensile Strength N	Weight kg/m
C12B-1	3/4 inch	11.68	12.07	5.72	16.1	27.3	0.89	29000	1.3
C16B-1	1 inch	17.02	15.88	8.28	21.0	41.5	2.10	64000	3.0
CL16B-1	1 inch	17.02	15.88	8.28	24.0	41.5	2.10	64000	3.2
C20B-1	1 1/4 inch	19.56	19.05	10.19	26.0	46.0	2.95	98000	4.1
C24B-1	1 1/2 inch	25.40	25.40	14.63	33.0	58.5	5.54	170000	7.9

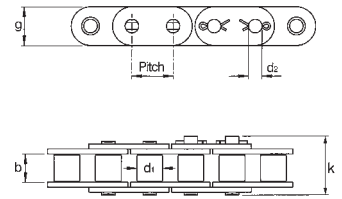

Special Metric Pitch Chains

Two sizes of chains produced to metric pitch employed on a number of continental machines. M20 is a custom design whilst M30 is 16B chain extended to 30mm pitch.

Cat. No.	Pitch P	Inside Width b min. mm	Roller ϕ d: max mm	Pin ϕ d: max mm	Plate Depth g mm	Pin Length k max mm	Bearing Area cm ²	Tensile Strength N	Weight kg/m
M20	20mm	16.00	12.00	6.00	19.0	35.5	1.36	35500	2.00
M30	30mm	17.02	15.88	8.28	20.8	41.5	2.10	63000	2.33

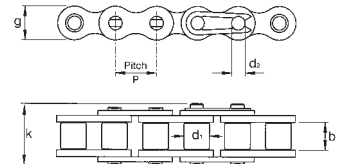

British Standard Double Pitch Chains

Double Pitch Chains use standard transmission chain pins, bushes, and rollers with link plates of double the pitch. These chains are used for both conveying and transmission on long centre distance drives, giving reduced weight and cost against the equivalent transmission chain.



Cat. No.	Pitch P	Inside Width b min. mm	Roller dia d: mm	Pin length l mm	Pin dia d2 mm	Plate Depth g mm	Plate Thickness t mm	Bearing Area cm ²	Tensile Strength N	Weight kg/m
208B	1 inch	7.75	8.51	16.2	4.45	11.6	1.52	0.50	17800	0.46
210B	1 1/4 inch	9.65	10.16	19.3	5.08	14.5	1.60	0.67	22300	0.57
212B	1 1/2 inch	11.68	12.07	21.8	5.72	15.8	1.78	0.89	29000	0.75
216B	2 inch	17.02	15.88	34.0	8.28	20.5	4.06	2.10	64500	1.70
220B	2 1/2 inch	19.56	19.05	41.2	10.19	26.0	4.50	2.95	95000	2.50
224B	3 inch	25.40	25.40	53.4	14.63	33.0	6.00	5.54	160000	4.80

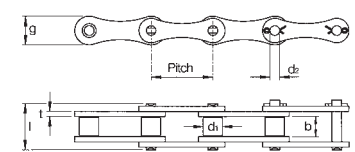

*Cat. No. equates to ISO 1275 Ref.

Special Conveying Chains

In addition to the standard attachments for roller chains, as shown on pages 16 and 17, Cross+Morse supply many special attachments for both standard pitch and extended pitch chains in standard steel and stainless steel materials. Cross+Morse have specialised in the many chains used for conveying applications in the Food, Beverage, Pharmaceutical, and Aerosol Can industries. Special production techniques enable early production of new designs, and replacement of existing obsolete products. Typical is the Foil Conveying Chain below.

Foil Conveying Chains

Foil conveying chains are based on 1/2" pitch B.S. Roller Chain type 08B1. They have been designed for the transport of foil, plastic and paper, the firm grip obtained with the chains maintaining tension in the materials when passed through heatforming or pressing operations. The base chain is electro-less nickel plated with the attachment parts all manufactured from stainless steel. In addition to simplex chain the attachments can be fitted to duplex chains enabling improved support and guidance of the assembly. The foil conveying chains operate on special design sprockets which open the clips as the chain passes around them. The material to be conveyed is fed into the open clips and retained as the clips close on leaving the sprocket. The material is discharged at the tail shaft of the conveyor by the reverse process.

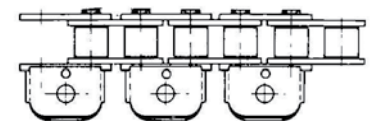

Foil Conveying Chain

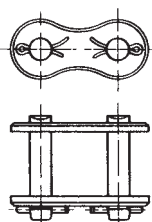
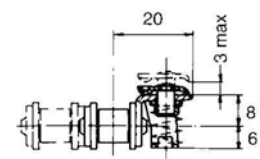

Connecting Link (Cottered Type)
For chains over 1" Pitch, for easy chain assembly

Part Ref. 75

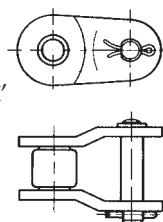

Single Crank Link
Used to make chains of Odd Pitch Lengths - Standard on chains over 1" pitch and optional on chains up to 1".

Part Ref. 87

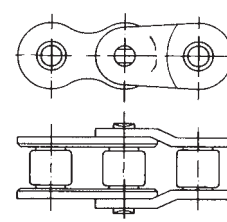

Double Crank Link
Preferred to Single Crank Link for small pitch chains. Available all chains to 1" pitch.

Part Ref. 86

Tel +44(0) 121 360 0155

Fax +44(0) 121 325 1079

Email sales@crossmorse.com

British Standard Roller Chain Attachments



The attachments below are available on 72 hour service built into the base roller chain at spacings to suit the application, K & M attachments can be fitted to only one side of the chain or both sides (as illustrated). Attachments of different types can be fitted in one chain assembly. In addition to these standard attachments, specials to suit customers' specific requirements can be supplied. Attachments can be assembled into Duplex and Triplex Chains, as well as standard Simplex. Nickel Plated chains can also be supplied to order. All Standard Attachments are made basically to ISO 606 Standard to ensure full interchangeability.

Bent Attachments

K1 - Single Hole Bent Attachment

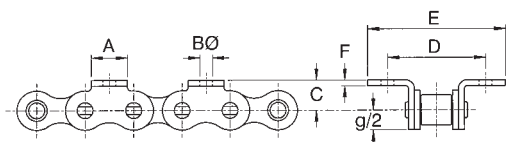

Base Chain Ref.	Pitch P	Attach Width A	Hole Dia B	Plate Height C	Transverse Pitch D	Overall Width E	Plate Thick F
08B-1	1/2"	11.5	4.2	8.9	23.8	36	1.5
10B-1	5/8"	12.8	5.3	10.3	31.8	45	1.5
12B-1	3/4"	16.6	7.1	13.5	38.1	58	1.8
16B-1	1"	20.0	6.7	15.9	50.8	73	3.2

K2 - Two Hole Bent Attachment

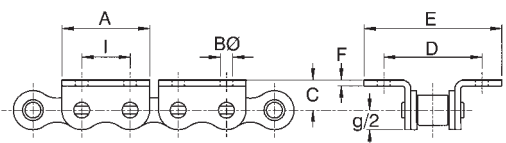

Base Chain Ref.	Pitch P	Attach Width A ₁	Hole Dia B	Plate Height C	Transverse Pitch D	Overall Width E	Plate Thick F	Hole Pitch I
08B-1	1/2"	23.4	4.9	8.9	25.4	40	1.5	12.7
10B-1	5/8"	28.6	5.3	10.3	31.8	49	1.5	15.9
12B-1	3/4"	34.0	6.5	13.5	38.1	52	1.8	19.1
16B-1	1"	46.0	6.7	15.9	50.8	73	3.2	25.4

Note:- If required plates can be supplied without holes, or with position/diameter of holes of non-standard sizes on short delivery.

Straight Attachments

M1 - Single Hole Straight Attachment

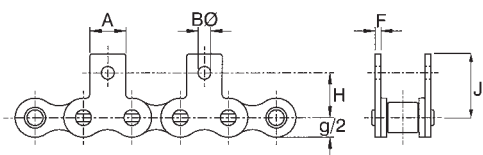

Base Chain Ref.	Pitch P	Attach Width A	Hole Dia B	Hole Height H	Plate Height J	Plate Thick F
08B-1	1/2"	11.5	4.2	12.7	19.0	1.5
10B-1	5/8"	12.8	5.3	15.9	22.6	1.5
12B-1	3/4"	16.6	7.1	22.2	31.9	1.8
16B-1	1"	20.0	6.7	23.0	34.0	3.2

M2 - Two Hole Straight Attachment

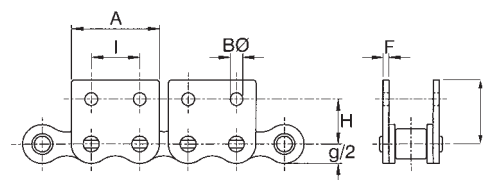

Base Chain Ref.	Pitch P	Attach Width A ₁	Hole Dia B	Hole Height H	Hole Pitch I	Plate Height J	Plate Thick F
08B-1	1/2"	23.4	4.9	13.0	12.7	20.8	1.5
10B-1	5/8"	28.6	5.3	16.5	15.9	24.9	1.5
12B-1	3/4"	34.0	6.5	21.0	19.1	28.2	1.8
16B-1	1"	46.0	6.7	23.0	25.4	34.0	3.2

All K & M attachments can be supplied without holes, or with the holes of different diameters and positions to standard. Also special shape attachments can be provided to customers drawings.

All dimensions in mm except where stated.

American Standard Precision Roller Chains Simplex (Single Strand) Construction



Conforming to ANSI B29.1 and ISO 606*

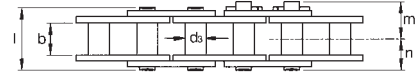
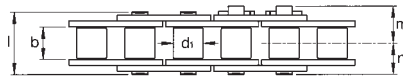
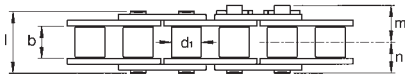
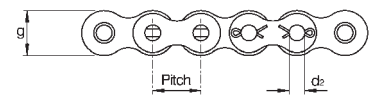
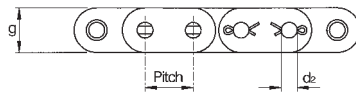
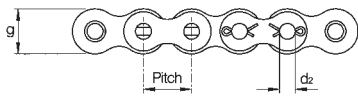

Standard Roller Chains

Straight Sideplate Roller Chains

Bush (Rollerless) Chains

*ISO 606 covers Standard Series Chains only

ANSI No.	Pitch P inches	Inside Width b min mm	Roller Ø d1 max. mm	Pin Ø d2 max. mm	Plate Depth g mm	Rivet Pin Length l max. mm	Length to Cotter Pin m mm	Length to Rivet Pin n mm	Bearing Area cm ²	Tensile Strength N	Approx Weight kg/m
*25	1/4	3.18	3.30 ¹⁾	2.29	5.9	7.9	4.9	3.9	0.11	3,500	0.13
*35	3/8	4.77	5.08 ¹⁾	3.58	9.0	12.0	8.7	6.0	0.27	8,400	0.31
41	1/2	6.35	7.77	3.58	9.9	13.2	9.4	6.6	0.32	8,000	0.42
40	1/2	7.85	7.95	3.96	11.8	16.6	10.7	8.3	0.44	14,800	0.62
50	5/8	9.40	10.16	5.08	15.0	20.2	14.3	10.1	0.70	24,400	1.04
60	3/4	12.60	11.91	5.94	18.0	25.0	16.3	12.5	1.06	34,400	1.48
80	1	15.80	15.88	7.92	24.0	32.6	18.8	16.3	1.79	64,500	2.50
100	1 1/4	19.00	19.05	9.53	30.0	39.2	23.2	19.6	2.62	100,000	3.76
120	1 1/2	25.25	22.23	11.10	36.0	49.4	29.0	24.7	3.94	130,000	5.50
140	1 3/4	25.25	25.40	12.70	42.0	53.0	31.0	26.5	4.72	177,000	7.20
160	2	31.55	28.58	14.27	48.0	63.2	37.1	31.6	6.50	227,000	9.80
180	2 1/4	35.50	35.71	17.45	54.5	71.5	44.2	35.8	8.87	320,000	13.0
200	2 1/2	37.85	39.68	19.85	59.5	77.0	47.3	38.5	10.90	360,000	16.3
240	3	47.35	47.63	23.80	72.0	95.5	57.7	47.8	16.15	520,000	25.3

Standard Series Chains (complying to ANSI b29.1)

Can be supplied also to full A.P.I. Specification with certified approval

• ANSI 25 and 35 are Bush Chains to ISO 1395

1) Bush Diameter

Heavy Series and High Endurance Chains

Morse High Strength Roller Chains are designed to meet the instantaneous peak loading requirements of all applications ranging from rugged construction equipment to elevated personnel carriers.

There are two series of chains, both operate on standard ANSI sprocket. The 'H' series have link plates of increased thickness to resist fatigue failure from shock and pulsating loads. Chains prefixed '8' have through hardened pins for additional strength where very high shock loads are encountered.

60H	3/4	12.60	11.91	5.94	18.0	28.3	16.6	14.2	1.15	34,000	1.70
80H	1	15.80	15.88	7.92	24.0	35.9	20.4	18.0	1.92	64,500	2.88
100H	1 1/4	19.00	19.05	9.53	30.0	42.5	25.0	21.3	2.77	100,000	4.55
120H	1 1/2	25.25	22.23	11.10	36.0	52.7	30.8	26.4	4.12	130,000	6.62
140H	1 3/4	25.25	25.40	12.70	42.0	56.0	32.6	28.0	4.93	177,000	8.45
160H	2	31.55	28.58	14.27	48.0	66.2	38.7	33.1	6.69	227,000	10.9
180H	2 1/4	35.50	35.71	17.45	54.5	75.0	44.5	37.5	9.14	320,000	13.6
200H	2 1/2	37.85	39.68	19.85	59.5	92.4	51.3	46.2	11.54	360,000	20.1

8-60H	3/4	12.60	11.91	5.94	18.0	28.3	16.6	14.2	1.15	40,000	1.70
8-80H	1	15.80	15.88	7.92	24.0	35.9	20.4	18.0	1.92	84,000	2.88
8-100H	1 1/4	19.00	19.05	9.53	30.0	42.5	25.0	21.3	2.77	120,500	4.55
8-120H	1 1/2	25.25	22.23	11.10	36.0	52.7	30.8	26.4	4.12	168,000	6.62
8-140H	1 3/4	25.25	25.40	12.70	42.0	56.0	32.6	28.0	4.93	224,000	8.45
8-160H	2	31.55	28.58	14.27	48.0	66.2	38.7	33.1	6.69	280,000	10.9
8-180H	2 1/4	35.50	35.71	17.45	54.5	75.0	44.5	37.5	9.14	380,000	13.6
8-200H	2 1/2	37.85	39.68	19.85	59.5	92.4	51.3	46.2	11.54	415,000	20.1

Straight Side Plate Chains

Provide increased bearing area for conveying applications, when sliding on guides. Operate on std. ANSI sprockets.

C40	1/2	7.85	7.95	3.96	11.7	16.6	10.7	8.3	0.44	14,800	0.67
C60	3/4	12.60	11.91	5.94	17.3	24.9	16.3	12.5	1.06	34,000	1.57
C80	1	15.80	15.88	7.92	24.2	32.6	18.8	16.3	1.79	64,500	2.79
C100	1 1/4	19.00	19.05	9.53	28.7	39.2	23.2	19.6	2.62	100,000	4.42
C120	1 1/2	25.25	22.23	11.10	36.1	49.4	29.0	24.7	3.94	130,000	6.55

Bush Chains

Standard ANSI Simplex chains assembled without rollers for reduced weight. Used on slow speed drives and lifting equipment such as, fork lift trucks.

ANSI No.	Pitch P inches	Inside Width b min mm	Roller Ø d1 max. mm	Pin Ø d2 max. mm	Plate Depth g mm	Rivet Pin Length l max. mm	Length to Cotter Pin m mm	Length to Rivet Pin n mm	Bearing Area cm ²	Tensile Strength N	Approx Weight kg/m
65	3/4	12.60	8.36	5.94	18.0	25.0	16.3	12.5	1.06	34,000	1.10
85	1	15.80	11.23	7.92	24.0	32.6	18.8	16.3	1.79	64,500	1.95
105	1 1/4	19.00	13.49	9.53	30.0	39.2	23.2	19.6	2.62	100,000	3.10
125	1 1/2	25.25	15.82	11.10	36.0	49.4	29.0	24.7	3.94	130,000	4.40

Detachable Chains

Detachable Chain can be supplied for chains of 3/4" pitch and above, in standard series, heavy series and high endurance series, add suffix 'C' to Part No. - e.g. 2" Pitch Triplex Detachable Chain - Ref. 160 - 3C.

Spares for Std. Chains

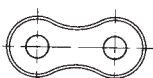

Pin Unit
(Rivetting Outer Links)

Available all sizes of chain. Press fit unit to connect chains for maximum performance

Part Ref. 79



Roller Unit
(Inner Link)

Available all sizes of chain to extend chain length or manufacture of special build chains.

Part Ref. 77

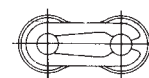

Connecting Link
(Spring Clip Type)

Standard all chains to 3/4" inch pitch. Should be assembled with open end away from running direction of chain.

Part Ref. 76

American Standard Precision Roller Chains Multi-Strand Constructions

Conforming to ANSI B29.1 and ISO 606*

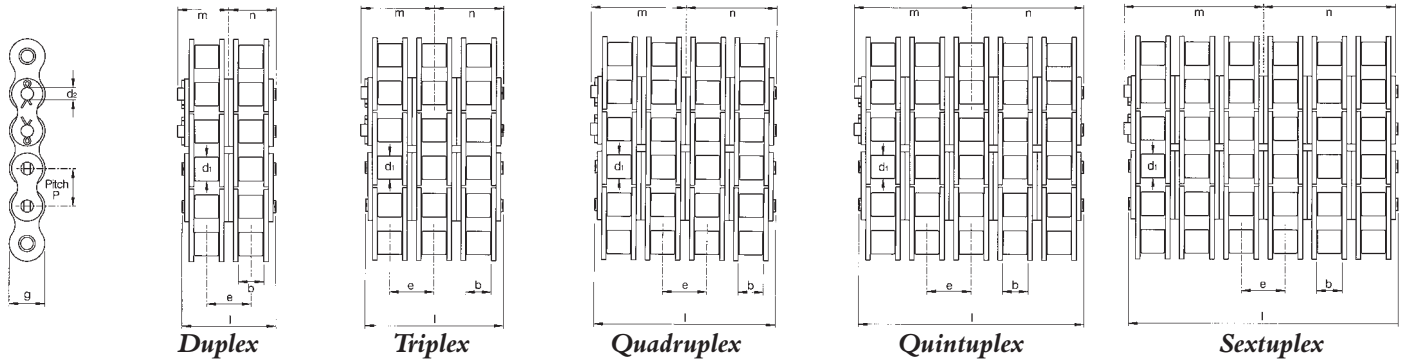

All chains available to full A.P.I. specifications with certified approval. *ISO 606 covers Duplex and Triplex construction only.

Duplex Chains

• 25-2 & 35-2 Bush Chains to ISO 1395

1) Bush diameter.

Triplex Chains

• 25-3 & 35-3 Bush Chains to ISO 1395

1) Bush diameter.

Quadruplex Chains

Quintuplex Chains

Sextuplex Chains

All dimensions in mm.

ANSI No.	Pitch P inches	Inside Width b min. mm	Roller Ø d1 max. mm	Pin Ø d2 max. mm	Plate Depth g mm	Transverse Pitch e mm	Rivet Pin Length l max. mm	Length to Cotter Pin m mm	Length to Rivet Pin n mm	Bearing Area cm ²	Tensile Strength N	Weight Approx. kg/m
•25-2	3/4	3.18	3.30 ₁₁	2.29	5.9	6.40	14.3	7.9	7.2	0.22	6,800	0.26
•35-2	3/8	4.77	5.08 ₁₁	3.59	9.0	10.13	22.0	11.9	11.0	0.54	16,800	0.65
40-2	1/2	7.85	7.95	3.96	11.8	14.38	30.9	16.8	15.2	0.88	29,600	1.22
50-2	5/8	9.40	10.16	5.08	15.0	18.11	38.3	21.2	19.2	1.40	48,800	2.00
60-2	3/4	12.60	11.91	5.94	18.0	22.78	48.1	26.4	24.1	2.12	68,000	2.85
80-2	1	15.80	15.88	7.92	24.0	29.29	61.8	33.6	30.9	3.58	129,000	5.00
100-2	1 1/4	19.00	19.05	9.53	30.0	35.76	75.3	41.3	37.7	5.24	200,000	7.60
120-2	1 1/2	25.25	22.23	11.10	36.0	45.44	95.3	52.0	47.6	7.88	260,000	10.8
140-2	1 3/4	25.25	25.40	12.70	42.0	48.87	102.6	55.6	51.3	9.44	354,000	14.2
160-2	2	31.55	28.58	14.27	48.0	58.55	122.6	66.7	61.4	13.00	454,000	19.0
180-2	2 1/4	35.50	35.71	17.48	54.5	65.84	137.2	74.7	68.6	17.75	640,000	26.2
200-2	2 1/2	37.85	39.68	19.84	59.5	71.55	150.9	83.4	75.4	21.80	720,000	32.0
240-2	3	47.35	47.63	23.80	72.0	87.83	184.1	99.5	92.1	32.30	1,040,000	49.5
•25-3	3/4	3.18	3.30 ₁₁	2.29	5.9	6.40	20.6	11.2	10.4	0.33	10,200	0.39
•35-3	3/8	4.77	5.08 ₁₁	3.59	9.0	10.13	32.2	17.9	16.1	0.80	25,200	0.97
40-3	1/2	7.85	7.95	3.96	11.8	14.38	45.2	24.6	22.4	1.32	44,500	1.83
50-3	5/8	9.40	10.16	5.08	15.0	18.11	56.4	30.6	28.2	2.10	73,300	2.97
60-3	3/4	12.60	11.91	5.94	18.0	22.78	70.9	38.1	35.5	3.18	102,100	4.35
80-3	1	15.80	15.88	7.92	24.0	29.29	91.1	48.4	45.6	5.73	193,600	7.90
100-3	1 1/4	19.00	19.05	9.53	30.0	35.76	111.1	59.2	55.6	7.86	300,000	11.4
120-3	1 1/2	25.25	22.23	11.10	36.0	45.44	140.7	74.7	70.4	11.82	390,000	15.8
140-3	1 3/4	25.25	25.40	12.70	42.0	48.87	151.6	80.2	75.8	14.16	531,000	21.5
160-3	2	31.55	28.58	14.27	48.0	58.55	181.2	96.1	90.6	19.50	681,000	26.3
180-3	2 1/4	35.50	35.71	17.48	54.5	65.84	203.0	107.2	101.6	26.63	960,000	39.6
200-3	2 1/2	37.85	39.68	19.84	59.5	71.55	222.4	119.5	111.2	32.70	1,080,000	47.7
240-3	3	47.35	47.63	23.80	72.0	87.83	272.0	143.4	136.0	48.45	1,560,000	73.8
40-4	1/2	7.85	7.95	3.96	11.8	14.38	59.6	31.8	29.6	1.76	59,300	2.44
60-4	3/4	12.60	11.91	5.94	18.0	22.78	93.7	49.3	46.9	4.24	136,000	5.86
80-4	1	15.80	15.88	7.92	24.0	29.29	120.4	62.8	60.2	7.16	232,000	10.07
100-4	1 1/4	19.00	19.05	9.53	30.0	35.76	146.8	77.0	73.4	10.48	384,000	15.0
120-4	1 1/2	25.25	22.23	11.10	36.0	45.44	186.1	97.3	93.1	15.76	520,000	22.6
140-4	1 3/4	25.25	25.40	12.70	42.0	48.87	200.4	104.8	100.2	18.88	705,000	29.9
160-4	2	31.55	28.58	14.27	48.0	58.55	239.7	125.5	119.9	26.00	908,000	38.8
200-4	2 1/2	37.85	39.68	19.84	59.5	71.55	293.9	155.2	147.0	43.60	1,440,000	63.3
240-4	3	47.35	47.63	23.80	72.0	87.83	359.8	187.3	179.9	64.60	2,080,000	98.5
60-5	3/4	12.60	11.91	5.94	18.0	22.78	116.5	60.6	58.3	5.30	170,000	7.32
80-5	1	15.80	15.88	7.92	24.0	29.29	149.7	77.5	74.8	9.31	290,000	12.6
100-5	1 1/4	19.00	19.05	9.53	30.0	35.76	182.6	95.0	91.3	13.10	480,000	18.8
120-5	1 1/2	25.25	22.23	11.10	36.0	45.44	231.6	120.1	115.8	19.70	680,000	28.2
140-5	1 3/4	25.25	25.40	12.70	42.0	48.87	249.3	128.6	124.7	23.60	920,000	36.2
160-5	2	31.55	28.58	14.27	48.0	58.55	298.3	154.0	149.2	32.50	1,160,000	52.9
60-6	3/4	12.60	11.91	5.94	18.0	22.78	139.3	81.9	79.5	6.36	204,000	8.78
80-6	1	15.80	15.88	7.92	24.0	29.29	178.9	102.0	99.4	11.46	348,000	15.10
100-6	1 1/4	19.00	19.05	9.53	30.0	35.76	218.4	122.9	119.2	15.72	576,000	22.5
120-6	1 1/2	25.25	22.23	11.10	36.0	45.44	277.0	153.1	148.8	23.64	816,000	33.9
140-6	1 3/4	25.25	25.40	12.70	42.0	48.87	318.1	163.0	159.0	28.32	1,105,000	43.4
160-6	2	31.55	28.58	14.27	48.0	58.55	376.8	193.2	188.4	39.00	1,395,000	58.1

Detachable Chains

Detachable Chain can be supplied for chains 3/4" pitch and above. Add suffix 'C' to Part No. e.g. Ref 160-3C for 2" pitch Triplex Detachable Chain

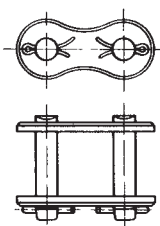

Connecting Link (Cottered Type)

For chains 3/4" Pitch and over for easy assembly of chains. Normally fitted slip fit plate except high endurance chains which are interference fit. Part Ref. 75

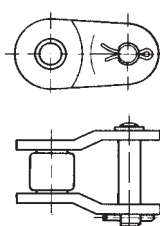

Single Crank Link

Used to make chains of Odd Pitch Lengths - Standard on all size ANSI Chains. Part Ref. 87

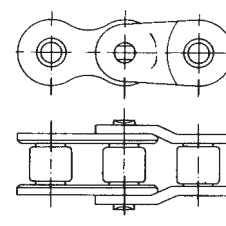

Double Crank Link

Preferred to Single Crank Link for small pitch chains. Available Chains to 3/4" pitch. Part Ref. 86